



**FAG**

## SES622-322-L [↗](#)

### Plummer block housing

Split plummer block housing for various bearing designs. The SNV series will be replaced by the new SES series in 2022.

## Technical information

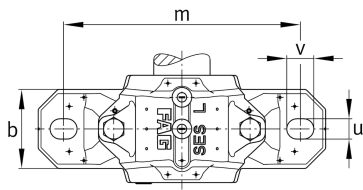

### Main Dimensions & Performance Data

D	240 mm	Outside diameter bearing
a	450 mm	Length base
h <sub>1</sub>	298 mm	Height
g	185 mm	Width housing body
K	90 mm	Width bearing seat
≈m	36.8 kg	Weight

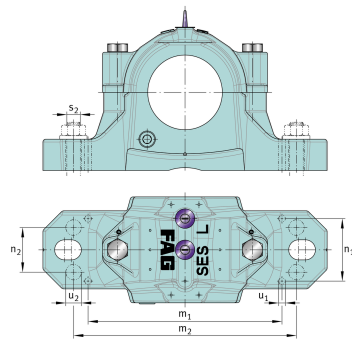
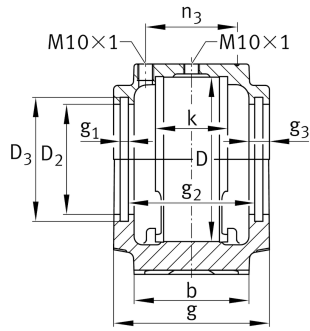
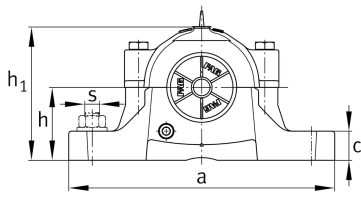

## Dimensions

b	130 mm	Width base
c	50 mm	Height base
h	150 mm	Base to shaft centerline height
m	390 mm	Distance fixing bore
s	25.4 mm	Screw size
s	M24	Size of fixing screws
u	28 mm	Width slot
v	35 mm	Length slot
D 2	147.5 mm	Diameter sealing
D 3	157.5 mm	Diameter sealing groove
D 5	154.7 mm	Outside diameter sealing labyrinth
g 1	6 mm	Width sealing groove
g 2	160.5 mm	Distance sealing
g 3	18 mm	Wall thickness
g 4	43 mm	Distance oil lubrication
m 1	338 mm	Distance holes aligned pins m1
n 3	120 mm	Distance lubrication
n 4	169 mm	Distance lubrication sealing
u 1	10 mm	Bore diameter u1
u 2	22 mm	Bore diameter u2