

TX Sleeves

Flare Tube End sleeves for metric tubes
SAE 070105 MS51533

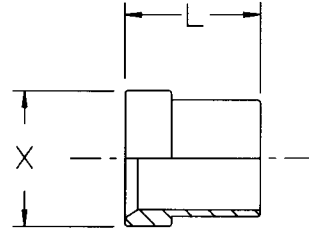

Tube Ø O.D. mm	L	X	Weight (steel) gr.
6	10.4	9.7	2
8	11.2	11.3	2
10	12.7	12.7	2
12	14.2	17.3	7
14	16.8	20.2	13
15	16.8	20.2	10
16	16.8	20.2	7
18	17.3	24.7	16
20	17.3	24.7	12
22	19.0	27.8	25
25	19.8	31.0	21
28	23.1	38.9	40
30	23.1	38.9	45
32	23.1	38.9	30
35	28.4	45.3	60
38	28.4	45.3	51
42	29.3	50.9	149

Tube Ø O.D. mm	Triple-Lok steel	Triple-Lok stainless steel	Triple-Lok brass
6	TXS6	TXSS6	TXB6
8	TXS8	TXSS8	TXB8
10	TXS10	TXSS10	TXB10
12	TXS12	TXSS12	TXB12
14	TXS14	TXSS14	TXB14
15	TXS15	TXSS15	TXB15
16	TXS16	TXSS16	TXB16
18	TXS18	TXSS18	TXB18
20	TXS20	TXSS20	TXB20
22	TXS22	TXSS22	TXB22
25	TXS25	TXSS25	TXB25
28	TXS28	TXSS28	TXB28
30	TXS30	TXSS30	TXB30
32	TXS32	TXSS32	TXB32
35	TXS35	TXSS35	TXB35
38	TXS38	TXSS38	TXB38
42	TXS42	TXSS42	TXB42

TX Sleeves

Flare Tube End sleeves for inch tubes
SAE 070105 MS51533

Tube Ø O.D. mm	L	X	Weight (steel) gr.
1/4	10.4	9.7	2
5/16	11.2	11.4	2
3/8	12.7	12.7	3
1/2	14.2	17.3	6
5/8	16.8	20.3	8
3/4	17.3	24.6	13
7/8	19.8	27.9	18
1	19.8	31.0	23
1.1/4	23.1	38.9	30
1.1/2	28.4	45.2	51
2	30.2	61.2	156

Tube Ø O.D. mm	Triple-Lok steel	Triple-Lok stainless steel	Triple-Lok brass
1/4	4TXS	4TXSS	4TXB
5/16	5TXS	5TXSS	5TXB
3/8	6TXS	6TXSS	6TXB
1/2	8TXS	8TXSS	8TXB
5/8	10TXS	10TXSS	10TXB
3/4	12TXS	12TXSS	12TXB
7/8	14TXS	14TXSS	14TXB
1	16TXS	16TXSS	16TXB
1.1/4	20TXS	20TXSS	20TXB
1.1/2	24TXS	24TXSS	24TXB
2	32TXS	32TXSS	32TXB

Only items priced in current price list are carried in stock.
 Design details and specifications subject to change without notice.